

RECOMMENDED P.C.B. LAYOUT
TOLERANCE UNSPECIFIED $\pm 0.05\text{mm}$

NOTES:

- 1.MATERIAL:
 - MOLDING: LCP UL94 V-0
 - CONTACT: COPPER ALLOY.
 - GOLD PLATED Min ON CONTACT AREA, 100u"
 - Min TIN (LEAD FREE) ON SOLDER AREA,
 - SHELL: SUS201-H, T=0.30 \pm 0.03mm
 - 50u" NICKEL PLATING OVER ALL.
- 2.MECHANICAL:
 - INSERTION: 5~20N.
 - EXTRACTION: 8~20N AFTER TEST.
 - DURABILITY: 5000 CYCLES
- 3.ELECTRICAL:
 - CURRENT: 3A FOR VBUS;
 - 1.25A FOR GND PIN.
 - 0.25A FOR OTHER.
 - VOLTAGE: 20 V MAX
 - WITHSTANDING VOLTAGE: 100V AC R.M.S.
 - CONTACT RESISTANCE: 40m Ω MAX.
 - INSULATION RESISTANCE: 100M Ω MIN.
- 4.ENVIRONMENTAL
 - TEMPERATURE RANGE -25 $^{\circ}$ C ~ +85 $^{\circ}$ C

设计:	Arvin: 2016.03.08	范围 Range	公差 Tolerance
审核:	Arvin:	X.X \pm	X.X ± 0.30
校对:	Ru yi:	X.XX \pm	X.XX ± 0.20
比例:	视角关系: $\odot \leftarrow$	X.XXX \pm	X.XXX ± 0.10
版次:	图框大小: A4	Angle \pm	Angle $\pm 5^{\circ}$

东莞市恒祺电子科技有限公司

名称: TYPE-C 料号:
 形号: 6PIN立插10.0
 共 张 , 第 张 备注:

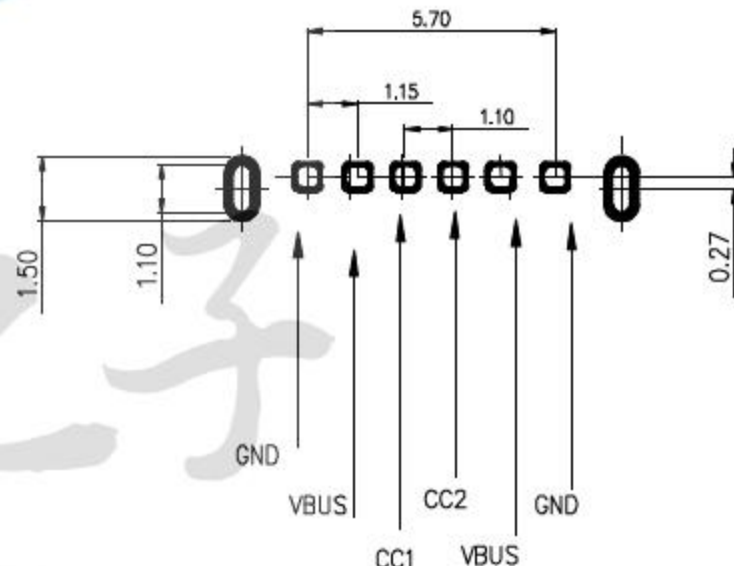
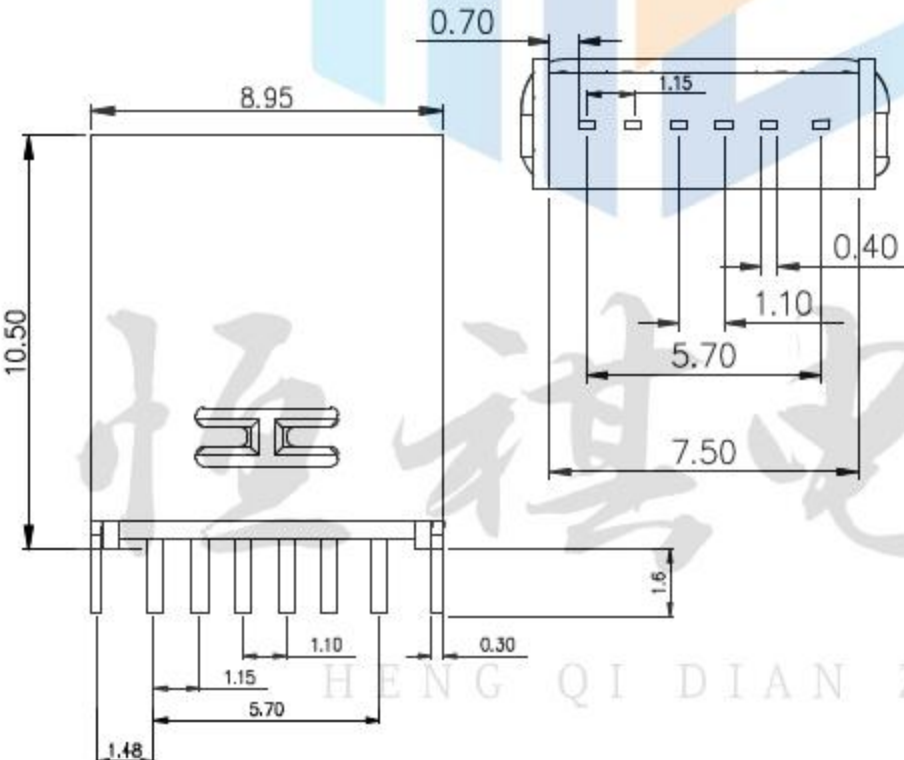
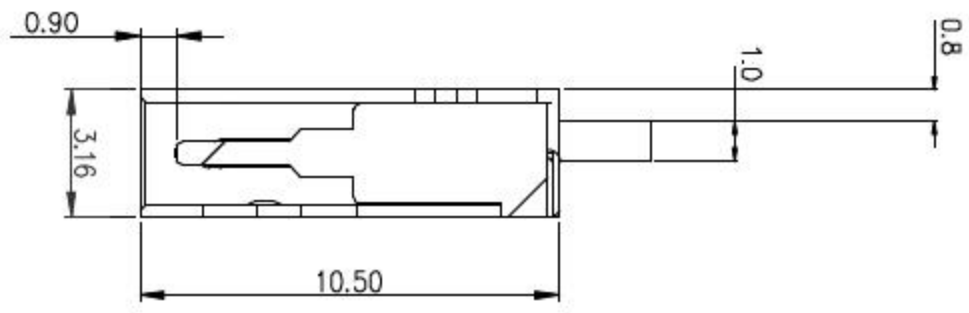
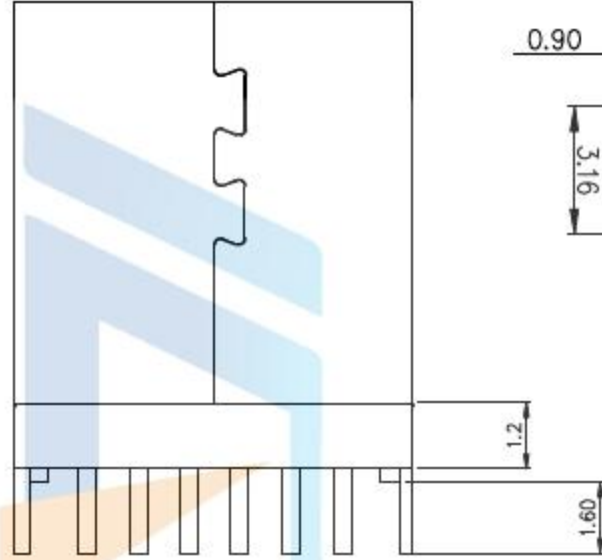
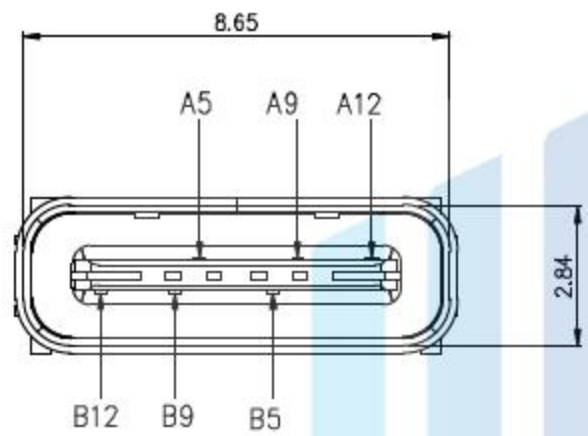

NOTES:

- 1.MATERIAL:
 - MOLDING: LCP UL94 V-0
 - CONTACT: COPPER ALLOY.
 - GOLD PLATED Min ON CONTACT AREA, 100u" Min TIN (LEAD FREE) ON SOLDER AREA,
 - SHELL: SUS201-H, T=0.30±0.03mm
 - 50u" NICKEL PLATING OVER ALL.
- 2.MECHANICAL:
 - INSERTION: 5~20N.
 - EXTRACTION: 8~20N AFTER TEST.
 - DURABILITY: 5000 CYCLES
- 3.ELECTRICAL:
 - CURRENT: 3A FOR VBUS;
 - 1.25A FOR GND PIN.
 - 0.25A FOR OTHER.
 - VOLTAGE: 20 V MAX
 - WITHSTANDING VOLTAGE: 100V AC R.M.S.
 - CONTACT RESISTANCE: 40mΩ MAX.
 - INSULATION RESISTANCE: 100MΩ MIN.
- 4.ENVIRONMENTAL
 - TEMPERATURE RANGE -25°C ~ +85°C

RECOMMENDED P.C.B. LAYOUT
TOLERANCE UNSPECIFIED ±0.05mm

设计:	Arvin: 2016.03.08	范围 Range	公差 Tolerance
审核:	Arvin:	X.X ±	X.X ±0.30
校对:	Ru yi:	X.XX ±	X.XX ±0.20
比例:	视角关系:	X.XXX ±	X.XXX ±0.10
版次:	图框大小: A4	Angle ±	Angle ±5°

东莞市恒祺电子科技有限公司

名称: TYPE-C 料号:
 形号: 6PIN立插10.5
 共 张 , 第 张 备注: